

CONNY
Wall and Railing Planter

Instructions for Use and
Safety Information

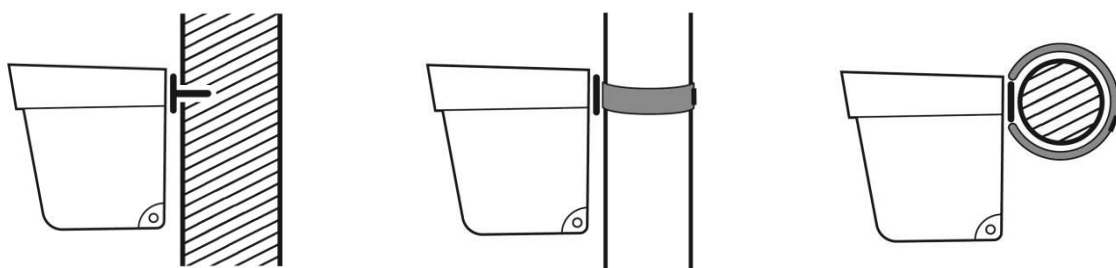

Item number: 320 016 / Issued: 07.2020

Dear Customer,

Thank you for choosing to purchase the Conny planter.



Please read these instructions through carefully before using your Conny.



Please keep the instructions for future reference. They provide important safety information for mounting and using your Conny.



Please ensure that you have read and understood the safety information.

OUR COMPANY ADDRESS:

Geli GmbH
Am Goldbach 1
63755 Alzenau-Michelbach
Germany

www.geli.de
info@geli.de

CONTENTS

1. General information	3
2. Identification and delivery contents	4
3. Intended use	5
3.2 Planting flowers	6
3.3 Correct mounting	7
3.4 Using as a wall planter	8
3.5 Using as a railing planter	10
4. Safety information	14
5. Modifications to Conny	16
6. Care and maintenance instructions	16
7. Transport and packaging	16
8. Storage	17
9. Environment and materials	17

1. General information

Conny is a planter for mounting on the wall or on vertical and horizontal struts with a **maximum diameter of 10cm** (e.g. on balcony railings, drainpipes or downpipes).

Conny is weatherproof and suitable for both indoor and outdoor use.



IMPORTANT

This product **must not be mounted** by persons (including children under 14 years of age) with reduced mental, sensory or intellectual capacities, unless they are supervised by a person responsible for their safety or receive instructions from this person on how to use the product.

WARNING – Do not leave **CHILDREN under 14 years of age** unsupervised.

WARNING – Do not let **CHILDREN** play with Conny.

WARNING – Keep plastic packaging material out of the reach of children, otherwise there is a risk of suffocation.

Conny was developed for private use and is not intended for commercial use.

CONNY IS NOT SUITABLE FOR USES OTHER THAN THOSE DESCRIBED BELOW. **WE ARE NOT LIABLE FOR MISUSE, DAMAGE, IMPROPER USE OR INCORRECT INSTALLATION.**

2. Identification and delivery contents

Conny delivery contents (item number 320 016)

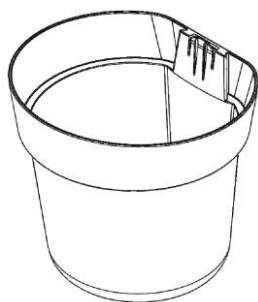

1 x planter

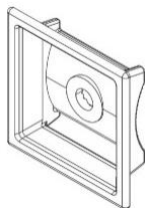

1 x mount bracket

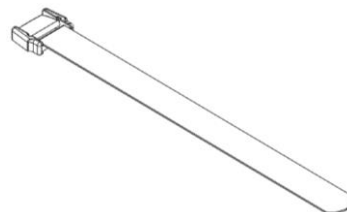

1 x strap with clasp



**ONLY USE THE ORIGINAL PARTS.
UNUSED PRODUCT PARTS MUST BE KEPT OUT OF THE REACH OF
CHILDREN.**

3. Intended use



IMPORTANT

- (i) *Do not use Conny if any of the components are damaged.*
- (ii) *Please ensure that Conny and all components are in working order before mounting. If anything is damaged, Conny should not be used.*
- (iii) *Only use original parts that have been approved by us.*
- (iv) *Spare parts or leftover Conny materials should be kept out of the reach of children.*
- (v) *Conny's service life depends on external factors such as direct sunlight, weather conditions and planting. Check regularly that Conny is safe and functioning, especially after a storm, adverse weather conditions (e.g. snow, rain) or strong gusts of wind. Check the strap regularly for defects.*
- (vi) *Only use the strap if it is functioning and undamaged. In particular, do not use the strap if there are tears, traces of weathering or visibly frayed areas.*
- (vii) *Please ensure that Conny is mounted in a location protected from the wind.*
- (viii) *The strap must be replaced **after 3 years** at the latest.*
- (ix) *Please contact us if you have any questions or concerns.*

3.2 Planting flowers

1. Fill the flowerpot and plant the flowers on firm ground.
 2. Fill the flowerpot with soil up to the lower edge of the rim.
- !! Please note that a **maximum plant height of 25cm** must not be exceeded!

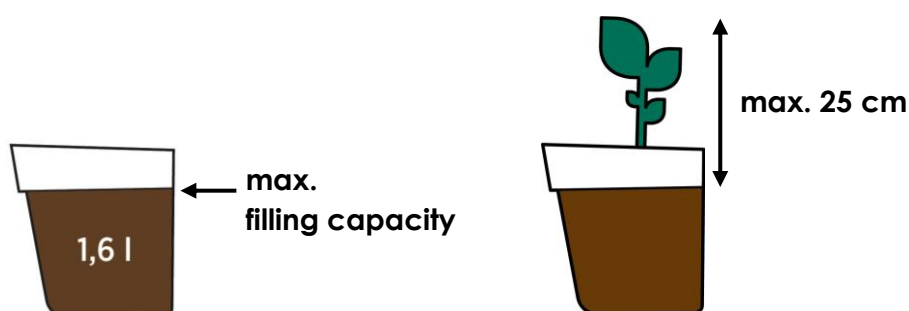

3. Conny's maximum total weight with plants and water is 1.8kg.

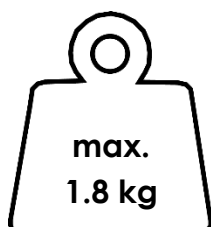

 Please make sure that the maximum weight is not exceeded despite growth.

TIP!

Outdoor use:

You can drill the recess marked on the bottom of the flowerpot to protect the plant from waterlogging.

3.3 Correct mounting

The Conny planter can be used as a railing pot or wall pot.

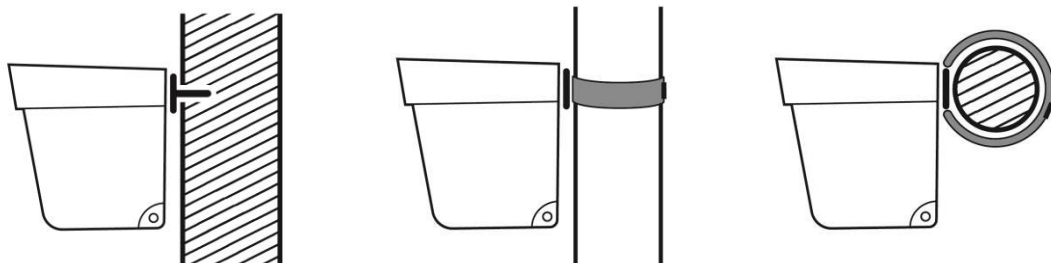

WARNING

- (i) Please make sure that there are no objects or people underneath the mounting area that could be injured.
- (ii) The maximum load of the flowerpot is 1.8kg. Please note that the weight may change due to watering or weather conditions.
- (iii) If you would like to mount the flowerpot using a strap, you will need a fixture with a maximum diameter of 10cm.
- (iv) Vertical slipping of the flowerpot on vertical struts should be prevented by a protrusion or a cross strut.

3.4 Using as a wall planter



IMPORTANT

!! Please make sure that the wall is suitable for mounting. This is not the case if, for example, the wall has cracks, if unusual noises can be heard while mounting or if the screw falls out of the wall. If in doubt, contact a professional.

!! The use of anchors may be necessary.

1.

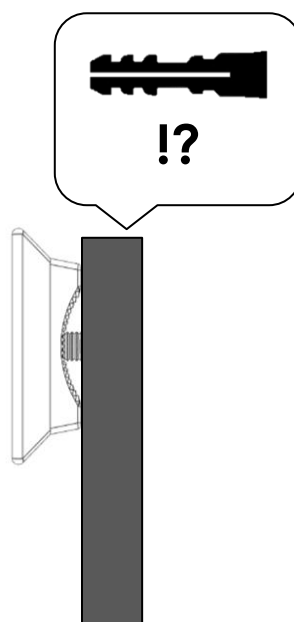
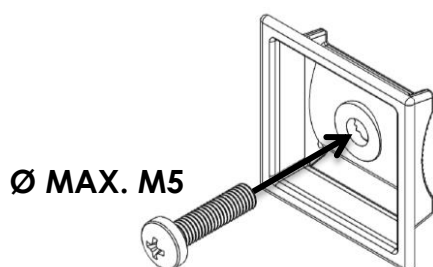

Use a screwdriver to countersink the second half of the screw. This will prevent the screw or anchor from being overtightened, which could result in a loose bracket.

2.

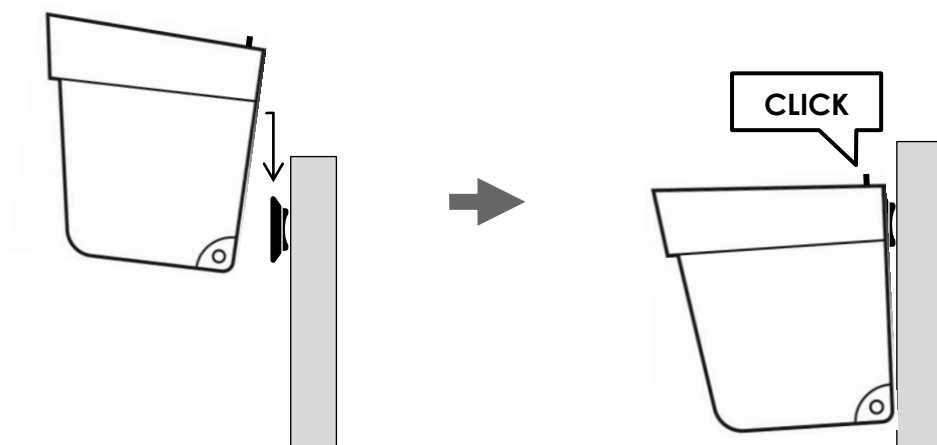

Please note that the flowerpot must be continuously attached to the wall.

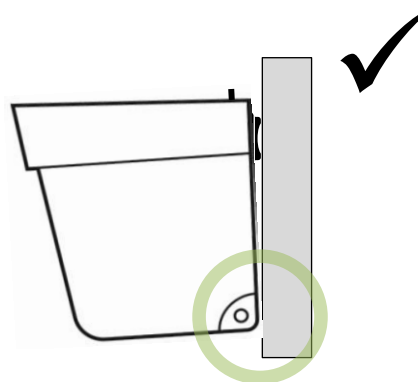
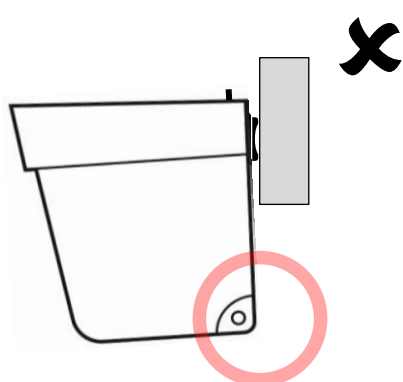

3.5 Using as a railing planter



IMPORTANT

!! Before mounting the flower pot, please check whether the location is suitable:

- ✓ **Diameter** of the strut should be **max. 10cm** (see Fig.1).
- ✓ **Vertical slipping is prevented** by a protrusion or a cross strut (see Fig. 2).
- ✓ **Check the location is secure and stable.**

Fig. 1

Ø MAX. 10cm



Abb. 2



1.

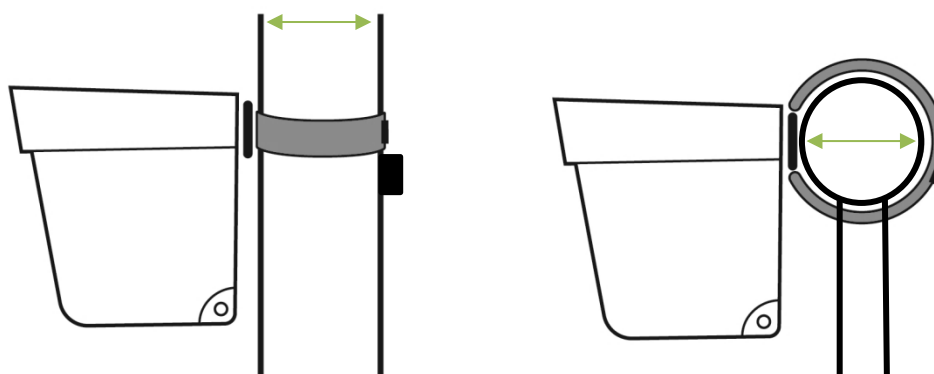
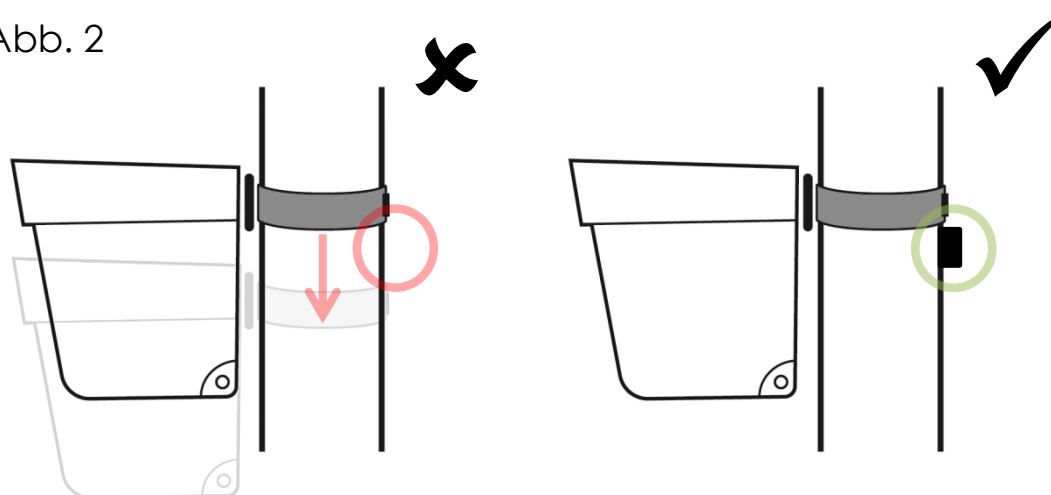
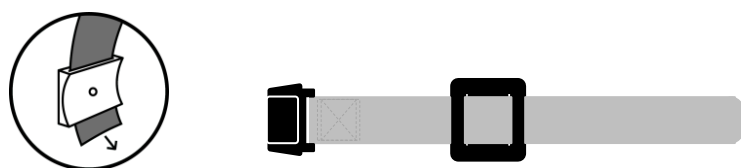

2. (1)

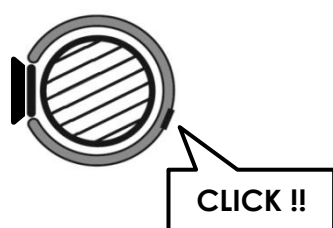

(2)

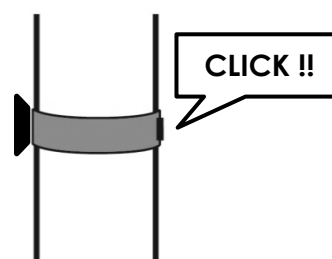

WARNING

IF THE CLASP IS NOT POSITIONED CORRECTLY, THE STRAP CAN COME LOOSE.



3. (1)

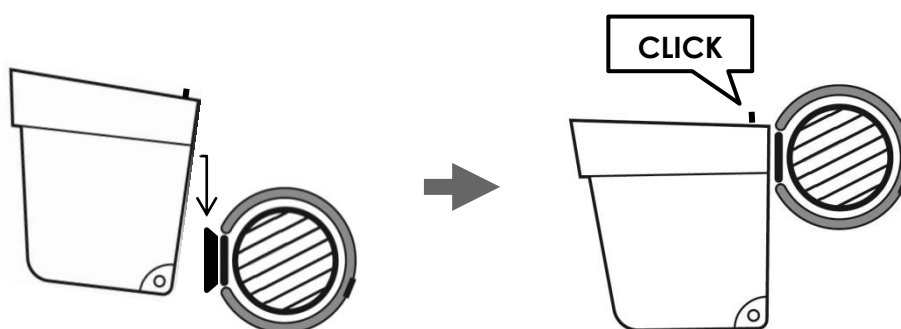

Please note that the flowerpot must be securely and stably attached to a suitable location and must not hang freely as illustrated.

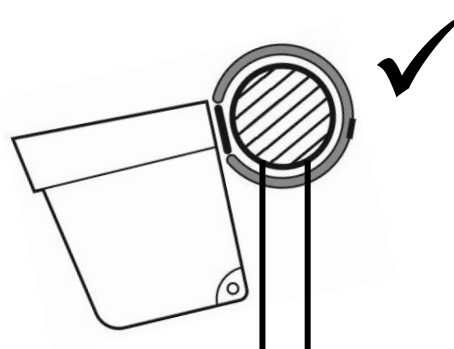
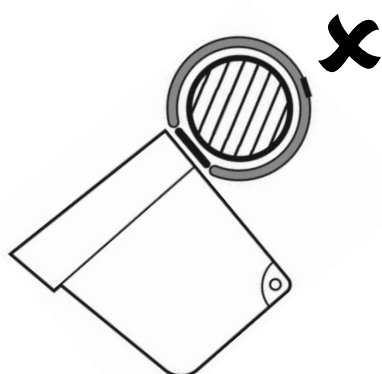

(2)

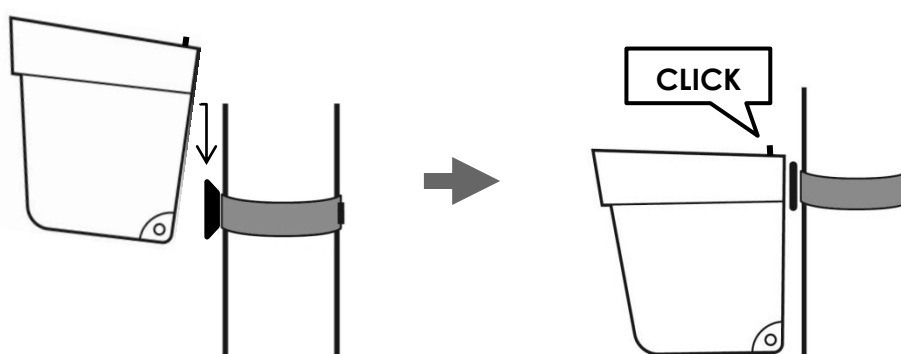

4.



IMPORTANT

Alignment and **additional securing of the flowerpot**. If you find that the strap alone does not provide sufficient stability and the flower pot could tip over or the bottom could move around too much, there is an additional opening at the rear lower end of the flower pot through which you can secure it with a suitable fastening element e.g. a wire or string.

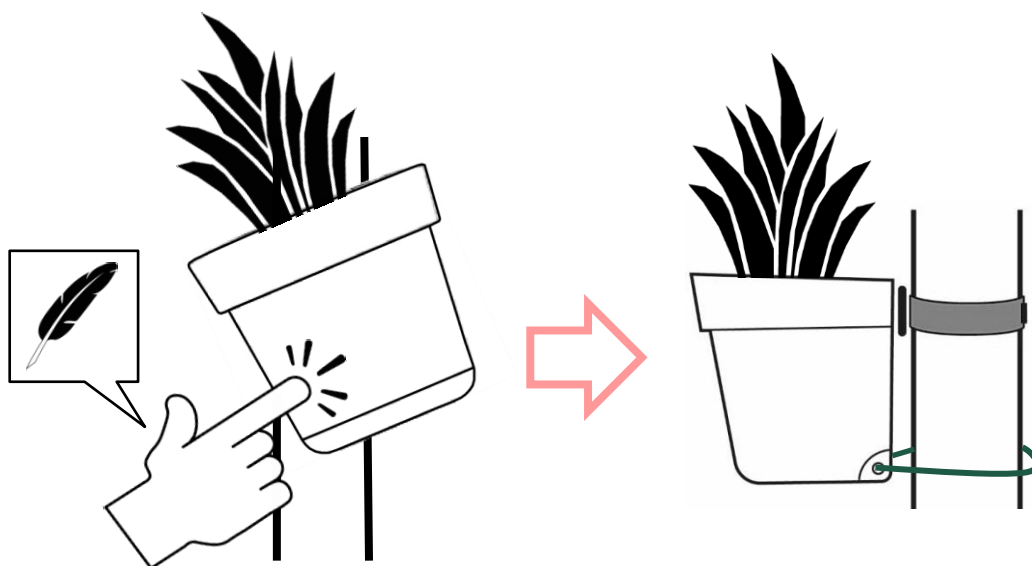
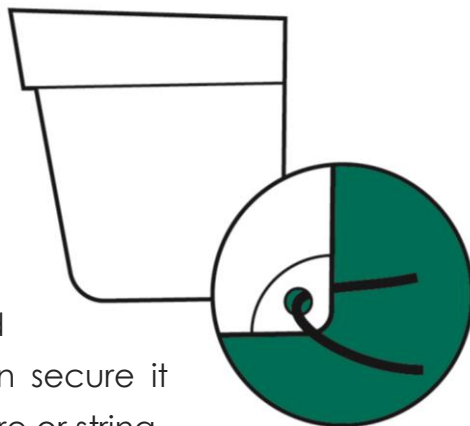

4. Safety information

FAILURE TO OBSERVE THE SAFETY INFORMATION MAY RESULT IN DAMAGE TO CONNY AND DANGER TO OTHER PERSONS AND THE PROPERTY OF THE USER.



IMPORTANT

- (i) Do not use Conny if any of the components are damaged.
- (ii) Please ensure that Conny and all components are in working order before mounting. If anything is damaged, Conny should not be used.
- (iii) Only use original parts that have been approved by us.
- (iv) Spare parts or leftover Conny materials should be kept out of the reach of children.
- (v) Repairs may only be carried out by us. If the product is defective, a spare part must be ordered.
- (vi) Conny is not designed to be used by persons (including children under 14 years of age) with reduced physical, sensory or mental capacities, unless they are supervised by a person responsible for their safety or have received instructions from this person on how to use the product.
- (vii) Children should be supervised to ensure that they do not play with Conny.
- (viii) Please note the maximum weight of 1.8kg (including plants and water). Please note that the weight may increase when used outdoors due to snow, rain and waterlogging.
- (ix) Check regularly that Conny is safe and functioning. While using the strap, regularly check that it is functioning properly.





WARNING

- (i) *Only use the strap if it is functioning and undamaged. In particular, do not use the strap if there are tears, traces of weathering or visibly frayed areas.*
- (ii) *Keep plastic packaging material out of the reach of children, otherwise there is a risk of suffocation.*
- (iii) *Please note that water may accumulate in the flowerpot and cause the weight to change.*
- (iv) *If required, please attach the bottom of the pot using a suitable fastening element, e.g. a wire or string.*

5. Modifications to Conny

It is **not permitted to use Conny in any other way** than the one described in the manual.

6. Care and maintenance instructions

The Conny planter should be cleaned with a damp cloth and mild soap solution.



IMPORTANT

After mounting, please **check at regular intervals** that the flowerpot is **attached and positioned correctly**, especially after storms (e.g. rain and wind) and extreme weather conditions (e.g. winter). Please check the strap for damage (cracks, weathering, frayed areas). If damaged, discontinue use of Conny and arrange for a replacement.

7. Transport and packaging

Width: 17.50cm
Height: 16.00cm
Length: 16.50cm
Weight: 0.16kg

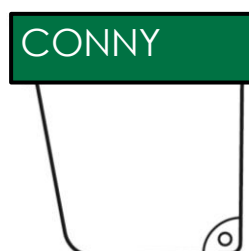

8. Storage

To protect the material, please take the Conny planter out of the sun when not in use.

9. Environment and materials

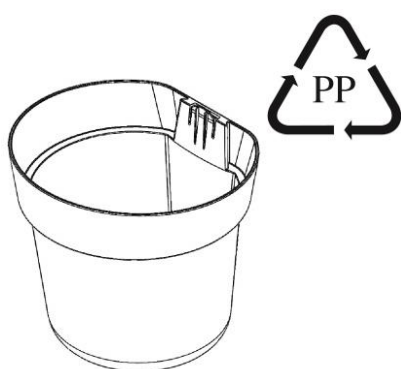

Planter

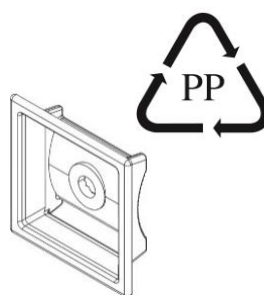

mount bracket



strap with clasp